

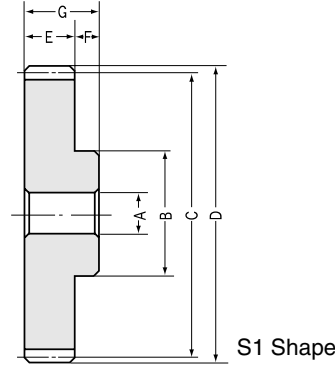

BSS Brass Spur Gears Modules 0.5~0.8



Specifications	
Precision grade	JIS N8 grade (JIS B1702-1: 1998) OLD JIS 4 grade (JIS B1702: 1976)
Gear teeth	Standard full depth
Pressure angle	20°
Material	Free cutting brass (C3604BD-F)
Heat treatment	—
Tooth hardness	Less than 80HRR
Surface treatment	—
Tooth surface finish	Cut
Datum reference surface for gear cutting	Bore
Secondary Operations	Possible

Module 0.5

Catalog No.	Module <i>m</i>	No. of teeth <i>z</i>	Bore AH7	Hub dia. B	Pitch dia. C	Outside dia. D	Face width E	Hub width F	Total length G	Shape	Allowable torque (N·m) NOTE 1		Backlash (mm) NOTE 2	Weight (gf)
											Bending strength	Bending strength		
BSS0.5-20	0.5	20	4	8.5	10	11	3	7	10	S1	0.0912	(0.0093)	0.06~0.16	4
BSS0.5-25	0.5	25	4	11	12.5	13.5	3	7	10	S1	0.1245	(0.0127)	0.1 ~0.2	8
BSS0.5-30	0.5	30	4	13	15	16	3	7	10	S1	0.1598	(0.0163)	0.1 ~0.2	11
BSS0.5-40	0.5	40	4	17	20	21	3	7	10	S1	0.2324	(0.0237)	0.1 ~0.2	20

Module 0.8

BSS0.8-20	0.8	20	5	13.5	16	17.6	4	8	12	S1	0.3099	(0.0316)	0.06~0.16	14
BSS0.8-25	0.8	25	5	17	20	21.6	4	8	12	S1	0.4266	(0.0435)	0.1 ~0.2	24
BSS0.8-30	0.8	30	5	20	24	25.6	4	8	12	S1	0.5462	(0.0557)	0.1 ~0.2	34
BSS0.8-40	0.8	40	5	20	32	33.6	4	8	12	S1	0.7943	(0.081)	0.1 ~0.2	46

NOTE 1: The allowable torques shown in the table are the calculated values according to the assumed usage conditions. Please see page 27 for more details.

NOTE 2: The backlash values shown in the table are the theoretical values of a pair of identical gears in mesh.